



# Bayshore Greek Fest

20 Hillcrest Road – Holmdel – N.J. – 07733

732-739-1515 [kimisisfestival@gmail.com](mailto:kimisisfestival@gmail.com)

[www.greekfestivalholmdel.com](http://www.greekfestivalholmdel.com)

## 2017 Festival Vendor Application & Agreement

Thursday, June 8 – 6:00 pm to 10:00 pm

Friday, June 9 – 5:00 pm to 11:00 pm

Saturday, June 10 – 1:00 pm to 11:00 pm

Sunday, June 11 – Noon to 8:00 pm

Name \_\_\_\_\_ Company \_\_\_\_\_

Cell Phone \_\_\_\_\_ Email \_\_\_\_\_

Address \_\_\_\_\_ City \_\_\_\_\_ State \_\_\_\_\_ Zip \_\_\_\_\_

Company Website \_\_\_\_\_

Products For Sale \_\_\_\_\_

**INSIDE Dining Hall - 10'x10' space (Electric Available):** \$495 \_\_\_\_\_ Location # \_\_\_\_\_  
**Tables Inside can be Pre-Ordered ONLY:** QTY. \_\_\_\_\_ @ \$15 ea. \_\_\_\_\_

**INSIDE Dining Hall - 10'x20' space (Electric Available):** \$695 \_\_\_\_\_ Location # \_\_\_\_\_  
**Tables Inside can be Pre-Ordered ONLY:** QTY. \_\_\_\_\_ @ \$15 ea. \_\_\_\_\_

**OUTSIDE – Bring your Tent - 10'x10' space (Electric Available)** \$395 \_\_\_\_\_ Location # \_\_\_\_\_  
**Tables Outside can be Pre-Ordered ONLY:** QTY. \_\_\_\_\_ @ \$15 ea. \_\_\_\_\_

**OUTSIDE – Bring your Tent - 10'x10' space (NO Electric Available)** \$345 \_\_\_\_\_ Location # \_\_\_\_\_  
**Tables Outside can be Pre-Ordered ONLY:** QTY. \_\_\_\_\_ @ \$15 ea. \_\_\_\_\_

**OUTSIDE – Bring your Tent - 10'x20' space (Electric Available)** \$545 \_\_\_\_\_ Location # \_\_\_\_\_  
**Tables Outside can be Pre-Ordered ONLY:** QTY. \_\_\_\_\_ @ \$15 ea. \_\_\_\_\_

### Please see page THREE for Booth Location Numbers

I would like to reserve: Location # \_\_\_\_\_ Amount \$ \_\_\_\_\_ Total Tables ( \$15 each ) \_\_\_\_\_ TOTAL \$ \_\_\_\_\_

AMOUNT ENCLOSED (50% deposit required to hold your requested space): \$ \_\_\_\_\_ Check # \_\_\_\_\_ Date \_\_\_\_\_

Vendor Signature : \_\_\_\_\_ Date : \_\_\_\_\_

PRINT Name : \_\_\_\_\_

- Locations can only be reserved with the submission of 50% of your payment and this completed application (pages 1 & 2). Spaces will be assigned on a first come, first paid basis.
- Please make checks payable to Kimisis Tis Theotokou Bayshore Greek Fest (please add “Vendor Name” & “Booth Location #” on check) and mail to 20 Hillcrest Road, Holmdel, New Jersey 07733.
- For questions contact Demetri at: [kimisisfestival@gmail.com](mailto:kimisisfestival@gmail.com)



# Bayshore Greek Fest

20 Hillcrest Road – Holmdel – N.J. – 07733

732-739-1515 [kimisisfestival@gmail.com](mailto:kimisisfestival@gmail.com)

[www.greekfestivalholmdel.com](http://www.greekfestivalholmdel.com)

## 2017 Festival Vendor Agreement

*Thursday, June 8 – 6:00 pm to 10:00 pm*

*Friday, June 9 – 5:00 pm to 11:00 pm*

*Saturday, June 10 – 1:00 pm to 12:00 am*

*Sunday, June 11 – Noon to 8:00 pm*

1. Booth locations are reserved once a minimum deposit of 50% is received. Spaces will be reserved on a first come, first paid basis. The balance is due by Friday, June 2, 2017. Reminders and confirmation will be sent to you by email.
2. Only merchandise that has been approved by a chairperson will be allowed at the Bayshore Greek Fest.
3. No food, drinks, or food products can be sold on premises.
4. No music is permitted in the booths.
5. Unloading & layout of your booth begins on Wednesday, June 7, 2017, after 2:00 pm & completed by 4:00 pm Thursday June 8.
6. Booths must be staffed and ready to open 30 minutes prior to the Bayshore Greek Fest's daily start times (listed above and must remain open until the Bayshore Greek Fest closes.
7. Vendors are prohibited from selling or displaying sexually explicit products, tobacco, alcohol, and illegal material.
8. No items should be nailed, stapled, taped or affixed in any way to walls, tables, or other Kimisis Tis Theotokou property.
9. All Fire Safety Codes, laws, and ordinances of Holmdel Township must be adhered.
10. Vendors are responsible for their booth's own setup / take down.
11. No security will be provide overnight at Kimisis Tis Theotokou Greek Orthodox Church.
12. Kimisis Tis Theotokou Greek Orthodox Church will NOT be responsible for any vendor property, any items left overnight, or after Sunday.
13. All vehicles / campers must be parked on the grass area to the right of church ONLY
14. No refunds will be provided due to inclement weather or any other reason.

**I have read and agree to comply with terms outlined in the Bayshore Greek Fest Vendor Application and Agreement forms. I understand that failure to abide by these outlined and agreed upon terms will result in removal of vendor in violation of these terms from the Bayshore Greek Fest and all monies will be forfeited and not be refundable.**

Vendor Signature \_\_\_\_\_ Date \_\_\_\_\_

Name ( Print ) \_\_\_\_\_



# Bayshore Greek Fest

20 Hillcrest Road – Holmdel – N.J. – 07733

732-739-1515 [kimisisfestival@gmail.com](mailto:kimisisfestival@gmail.com)

[www.greekfestivalholmdel.com](http://www.greekfestivalholmdel.com)

## 2017 Festival Vendor Booth Locations

**Please select location #**

**(example “ I-6E ” indicates INSIDE spot #6 with electric)**

Thursday, June 8 – 6:00 pm to 10:00 pm

Friday, June 9 – 5:00 pm to 11:00 pm

Saturday, June 10 – 1:00 pm to 12:00 am

Sunday, June 11 – Noon to 8:00 pm

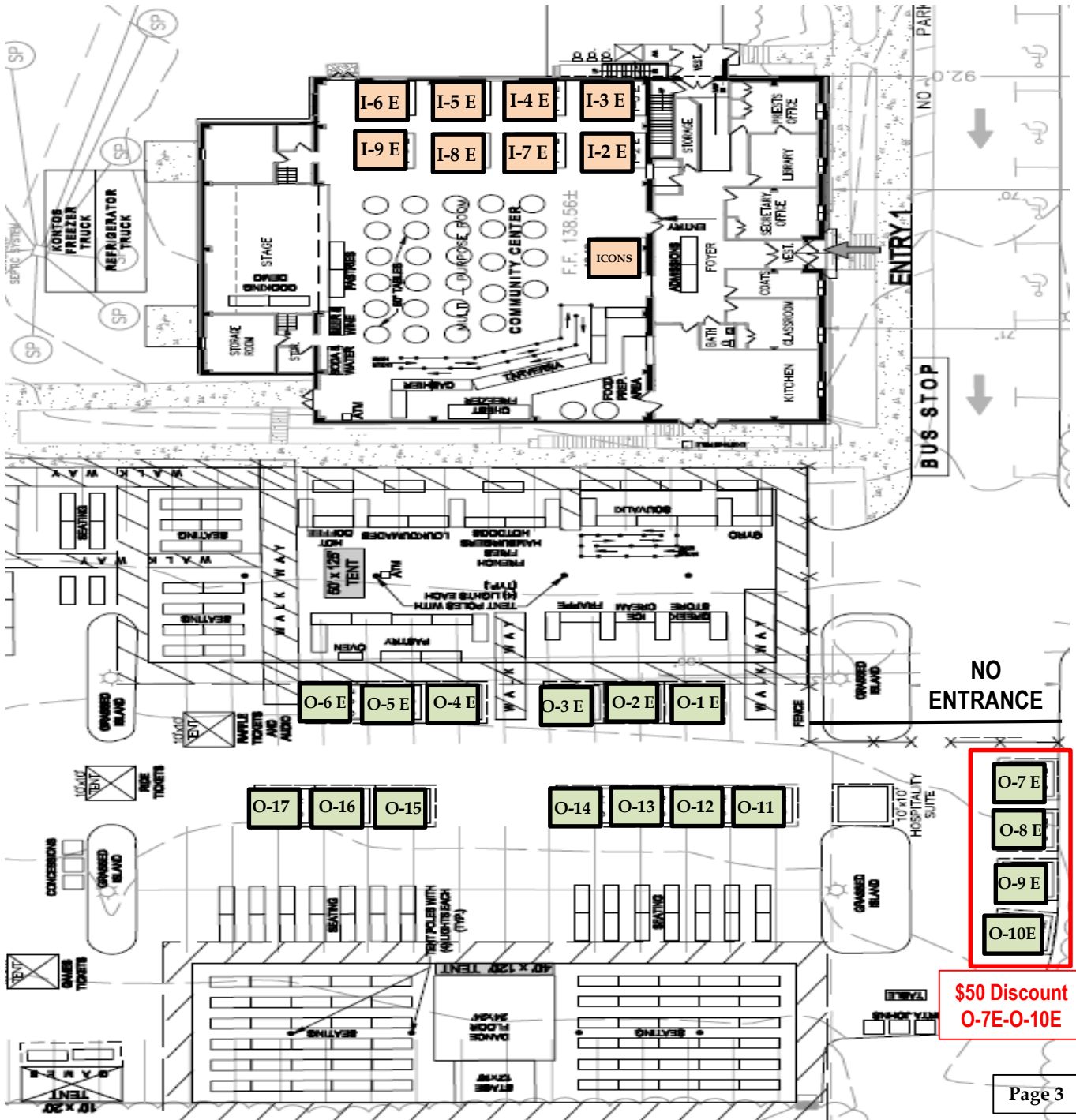

**\$50 Discount  
O-7E-O-10E**